

Ground Floor Plan

Shop	Carpets Area	S.B.A	Shop	Carpets Area	S.B.A	Shop	Carpets Area	S.B.A	Shop	Carpets Area	S.B.A
01	11'0"x18'0"	321	10	11'6"x22'0"	410	19	23'3"x14'9"	556	28	35'9"x12'1½"	701
02	11'6"x18'0"	335	11	11'6"x22'0"	410	20	11'0"x24'9"	441			
03	11'6"x18'0"	335	12	11'6"x22'0"	410	21	11'6"x24'9"	462			
04	11'6"x18'0"	335	13	11'6"x22'0"	410	22	11'6"x24'9"	462			
05	11'6"x18'0"	335	14	11'6"x22'0"	410	23	11'6"x24'9"	462			
06	11'6"x18'0"	335	15	11'6"x22'0"	410	24	11'6"x24'9"	462			
07	11'6"x18'0"	335	16	11'0"x22'0"	392	25	11'6"x24'9"	462			
08	35'9"x20'0"	1158	17	23'3"x14'9"	556	26	11'6"x24'9"	462			
09	35'9"x20'0"	1158	18	23'3"x15'9"	593	27	35'9"x12'1½"	701			

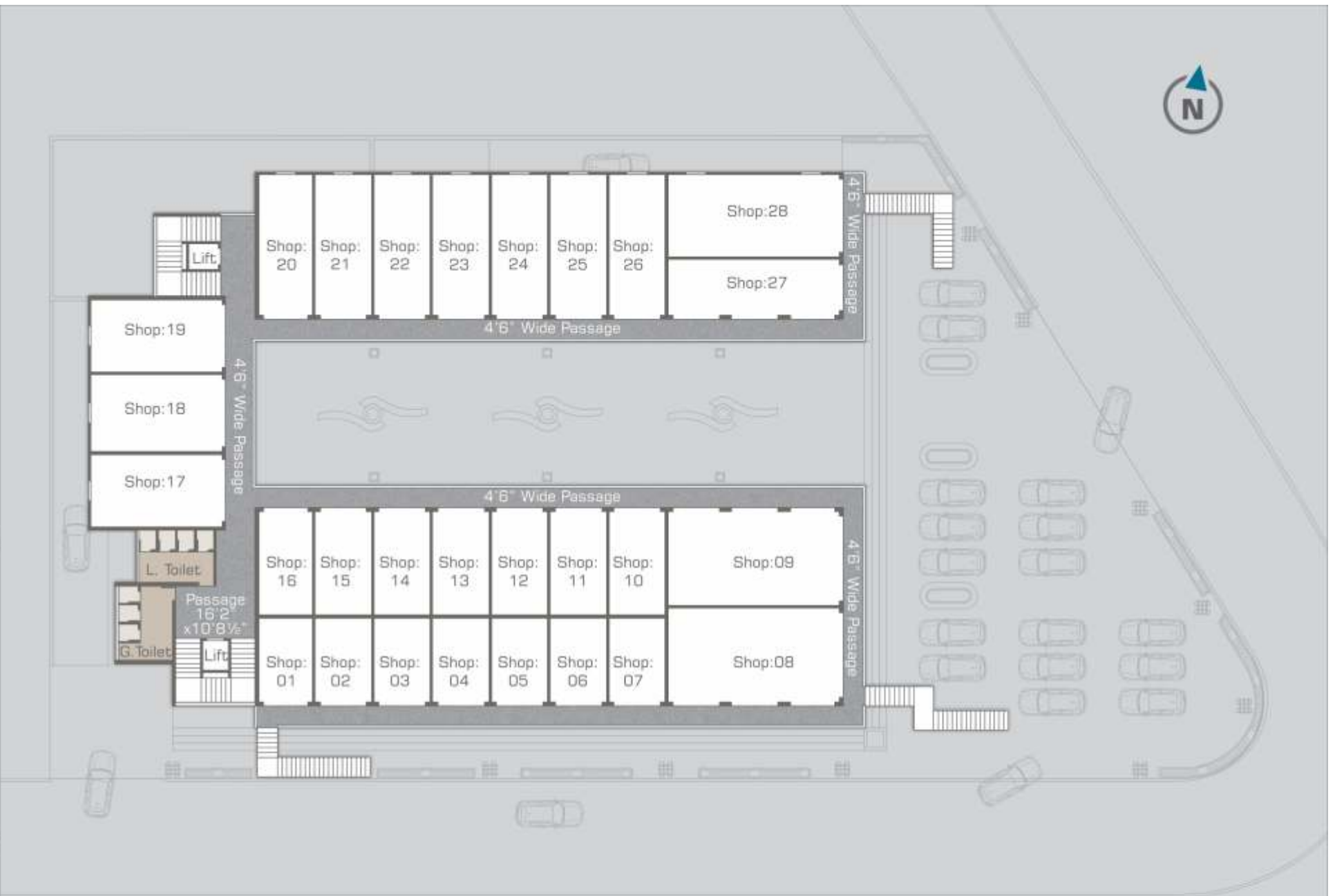

First Floor Plan

Shop	Carpets Area	S.B.A	Shop	Carpets Area	S.B.A	Shop	Carpets Area	S.B.A	Shop	Carpets Area	S.B.A
01	11'0"x18'0"	321	10	11'6"x22'0"	410	19	27'6"x14'9"	658	28	35'9"x16'10½"	977
02	11'6"x18'0"	335	11	11'6"x22'0"	410	20	11'0"x29'6"	527			
03	11'6"x18'0"	335	12	11'6"x22'0"	410	21	11'6"x29'6"	549			
04	11'6"x18'0"	335	13	11'6"x22'0"	410	22	11'6"x29'6"	549			
05	11'6"x18'0"	335	14	11'6"x22'0"	410	23	11'6"x29'6"	549			
06	11'6"x18'0"	335	15	11'6"x22'0"	410	24	11'6"x29'6"	549			
07	11'6"x18'0"	335	16	11'0"x22'0"	392	25	11'6"x29'6"	549			
08	35'9"x20'0"	1158	17	27'6"x14'9"	658	26	11'6"x29'6"	549			
09	35'9"x20'0"	1158	18	27'6"x15'9"	703	27	35'9"x12'1½"	701			

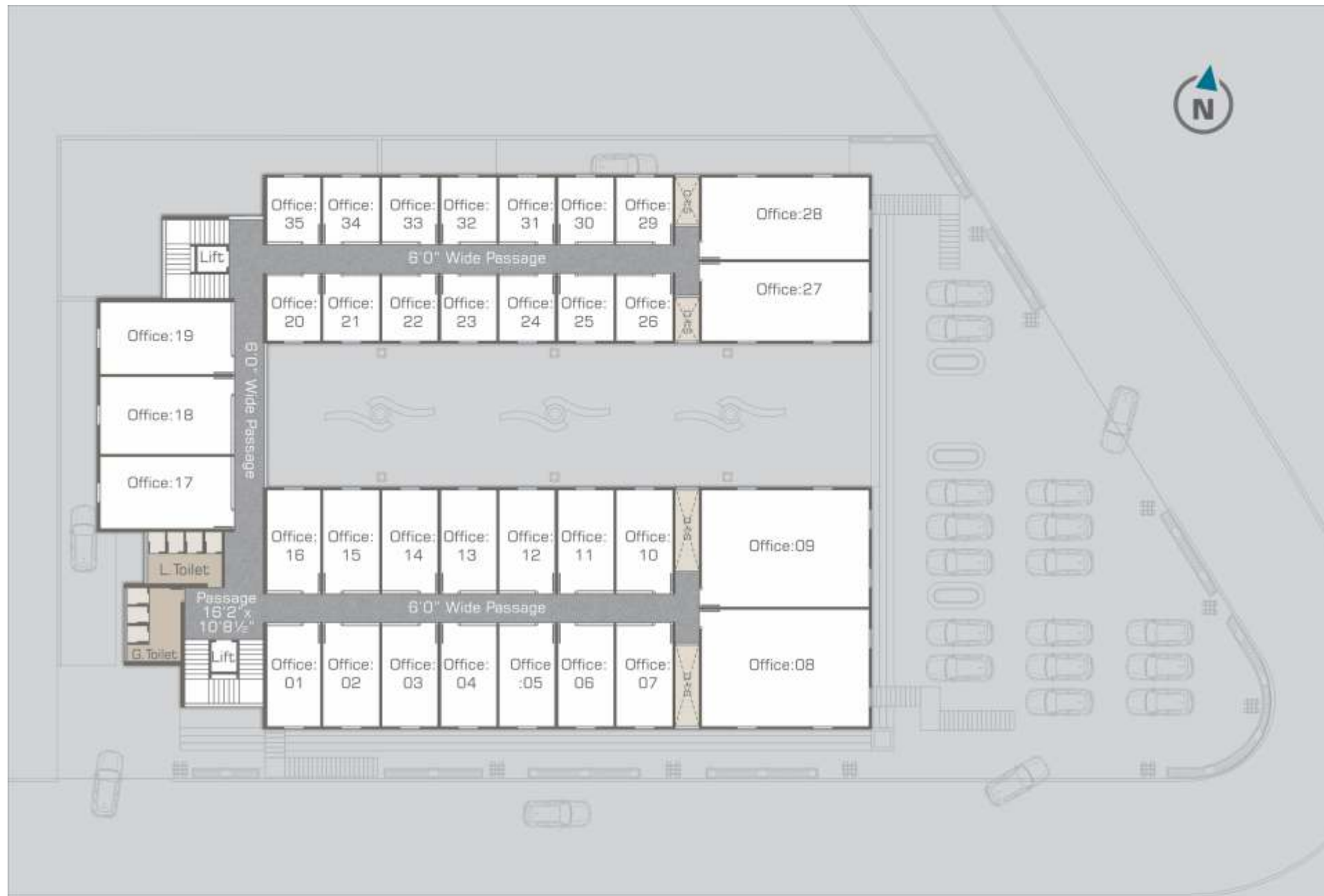

Second Floor Plan

Office	Carpet Area	S.B.A	Office	Carpet Area	S.B.A	Office	Carpet Area	S.B.A	Office	Carpet Area	S.B.A
01	11'0"x20'9"	369	10	11'6"x20'9"	387	19	27'0"x14'9"	645	28	34'3"x16'10½"	935
02	11'6"x20'9"	387	11	11'6"x20'9"	387	20	11'0"x13'3"	237	29	11'6"x13'3"	246
03	11'6"x20'9"	387	12	11'6"x20'9"	387	21	11'6"x13'3"	246	30	11'6"x13'3"	246
04	11'6"x20'9"	387	13	11'6"x20'9"	387	22	11'6"x13'3"	246	31	11'6"x13'3"	246
05	11'6"x20'9"	387	14	11'6"x20'9"	387	23	11'6"x13'3"	246	32	11'6"x13'3"	246
06	11'6"x20'9"	387	15	11'6"x20'9"	387	24	11'6"x13'3"	246	33	11'6"x13'3"	246
07	11'6"x20'9"	387	16	11'0"x20'9"	369	25	11'6"x13'3"	246	34	11'6"x13'3"	246
08	34'3"x24'0"	1332	17	27'0"x14'9"	645	26	11'6"x13'3"	246	35	11'0"x13'3"	237
09	34'3"x24'0"	1332	18	27'0"x15'9"	689	27	34'3"x16'1½"	893			

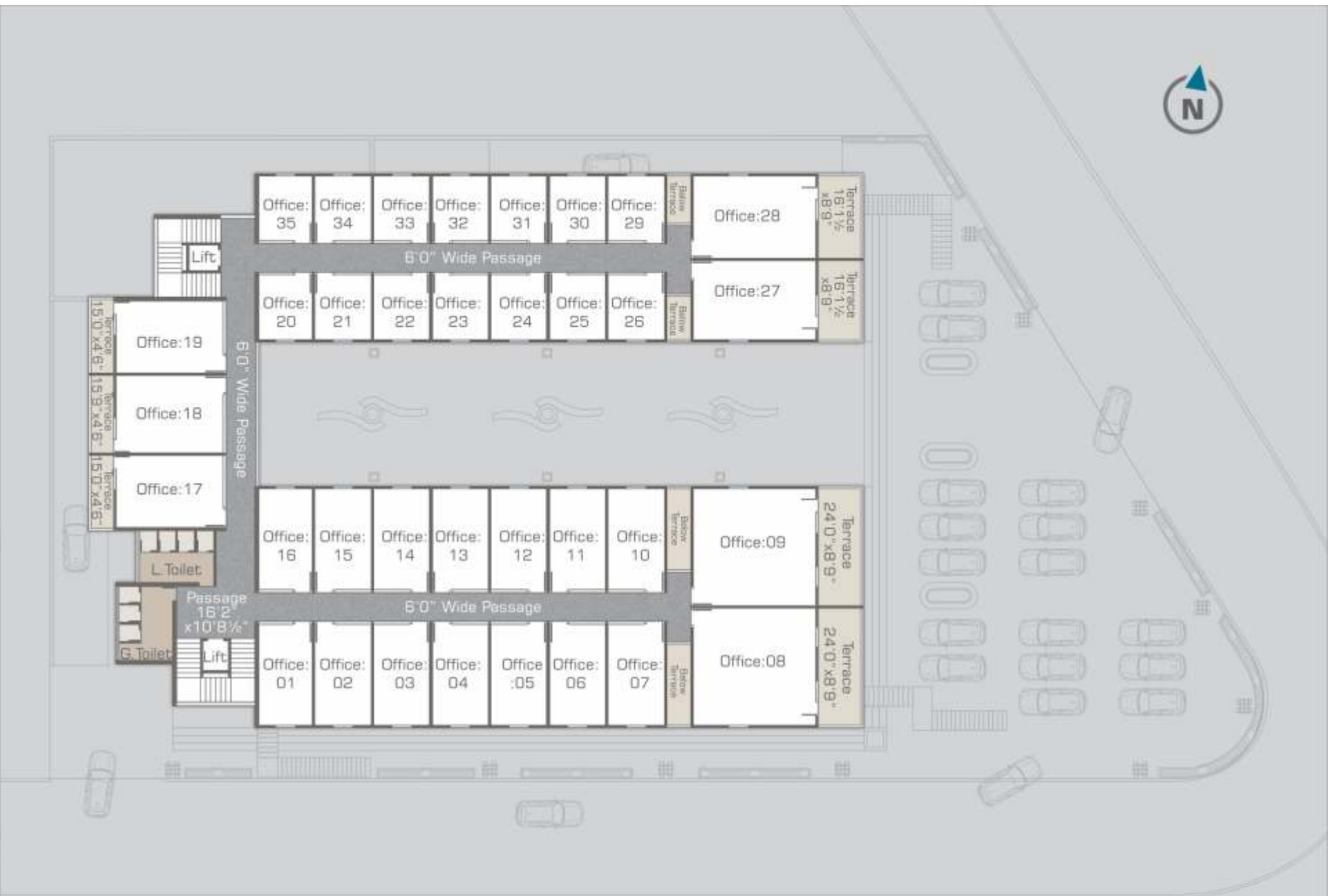

Third Floor Plan

Office	Carpet Area	S.B.A	Office	Carpet Area	S.B.A	Office	Carpet Area	S.B.A	Office	Carpet Area	S.B.A
01	11'0"x20'9"	369	10	11'6"x20'9"	387	19	22'0"x14'9"	526	28	25'0"x16'10½"	682
02	11'6"x20'9"	387	11	11'6"x20'9"	387	20	11'0"x13'3"	237	29	11'6"x13'3"	246
03	11'6"x20'9"	387	12	11'6"x20'9"	387	21	11'6"x13'3"	246	30	11'6"x13'3"	246
04	11'6"x20'9"	387	13	11'6"x20'9"	387	22	11'6"x13'3"	246	31	11'6"x13'3"	246
05	11'6"x20'9"	387	14	11'6"x20'9"	387	23	11'6"x13'3"	246	32	11'6"x13'3"	246
06	11'6"x20'9"	387	15	11'6"x20'9"	387	24	11'6"x13'3"	246	33	11'6"x13'3"	246
07	11'6"x20'9"	387	16	11'0"x20'9"	369	25	11'6"x13'3"	246	34	11'6"x13'3"	246
08	25'0"x24'0"	972	17	22'0"x14'9"	526	26	11'6"x13'3"	246	35	11'0"x13'3"	237
09	25'0"x24'0"	972	18	22'0"x15'9"	562	27	25'0"x16'1½"	652			



Fourth Floor Plan

Office	Carpets Area	S.B.A	Office	Carpets Area	S.B.A	Office	Carpets Area	S.B.A	Office	Carpets Area	S.B.A
01	11'0"x20'9"	369	10	11'6"x20'9"	387	19	22'0"x14'9"	526	28	25'0"x16'10½"	682
02	11'6"x20'9"	387	11	11'6"x20'9"	387	20	11'0"x13'3"	237	29	11'6"x13'3"	246
03	11'6"x20'9"	387	12	11'6"x20'9"	387	21	11'6"x13'3"	246	30	11'6"x13'3"	246
04	11'6"x20'9"	387	13	11'6"x20'9"	387	22	11'6"x13'3"	246	31	11'6"x13'3"	246
05	11'6"x20'9"	387	14	11'6"x20'9"	387	23	11'6"x13'3"	246	32	11'6"x13'3"	246
06	11'6"x20'9"	387	15	11'6"x20'9"	387	24	11'6"x13'3"	246	33	11'6"x13'3"	246
07	11'6"x20'9"	387	16	11'0"x20'9"	369	25	11'6"x13'3"	246	34	11'6"x13'3"	246
08	25'0"x24'0"	972	17	22'0"x14'9"	526	26	11'6"x13'3"	246	35	11'0"x13'3"	237
09	25'0"x24'0"	972	18	22'0"x15'9"	562	27	25'0"x16'1½"	652			

PROJECT HIGHLIGHT

- Aesthetically designed building as per vastu science.



- Well Designed common washrooms for the premises.
- Excellent frontage with magnificent visibility.

- Earthquake resistant structure design.
- D.G. back up for common utilities.



- Ample basement parking.
- Standard two elevators.



- Easy accessible and visible higher ground shopping floor from main road.



SPECIFICATIONS

- Adequate and standard concealed electrification with adequate points.
- Vitrified flooring.
- Fix outdoor A.C. unit location.

