

TWO LEVEL
BASEMENT
PARKING
PLAN

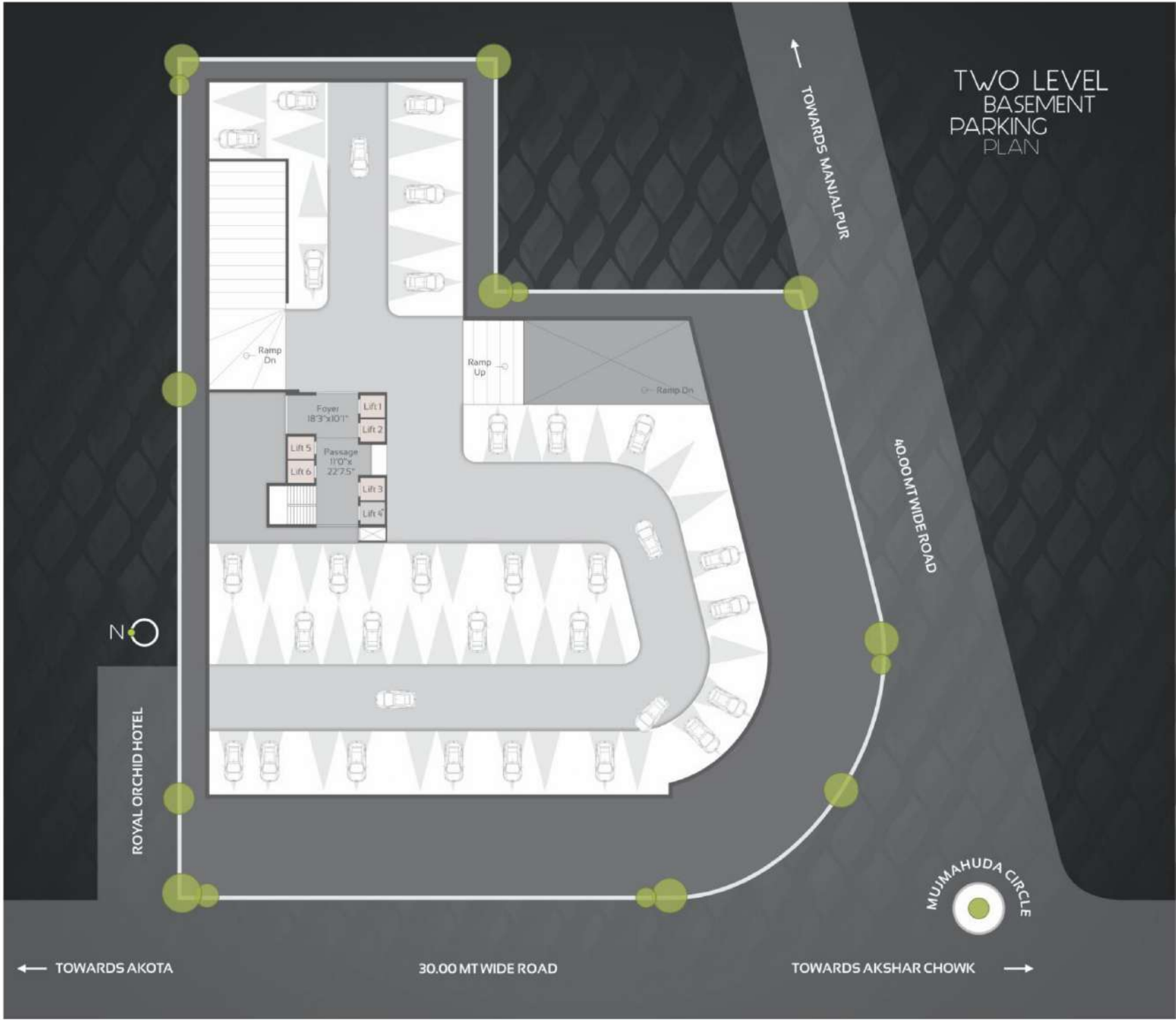

ROYAL ORCHID HOTEL

← TOWARDS AKOTA

30.00 MT WIDE ROAD

TOWARDS AKSHAR CHOWK →

TOWARDS MANJALPUR

40.00 MT WIDE ROAD



MUJIMAHUDA CIRCLE

GROUND FLOOR PLAN

No.	Area
01	1102
02	963
03	1004
04	1004
05	1004
06	1004
07	1004
08	1894
09	755
10	463
11	463
12	463
13	463
14	392



← TOWARDS AKOTA

30.00 MT WIDE ROAD

TOWARDS AKSHAR CHOWK →

* Lift No.4 is allotted to 12th floor

FIRST & SECOND FLOOR PLAN

No.	Area
01	1650
02	1126
03	985
04	985
05	985
06	985
07	985
08	1811
09	1026
10	735
11	737
12	735
13	744
14	899
15	650
16	590
17	648
18	648
19	1130



TYPICAL FLOOR PLAN

3rd to 12th floor

No.	Area
01	1435
02	981
03	976
04	976
05	975
06	976
07	975
08	2377
09	1572
10	846
11	848
12	846
13	1843
14	301
15	275
16	303
17	301
18	516
19	516
20	301
21	303
22	275
23	301



ROYAL ORCHID HOTEL

ENTRY

TOWARDS MANALI PARK

40.00 MT WIDE ROAD



TOWARDS AKOTA

30.00 MT WIDE ROAD

TOWARDS AKSHAR CHOWK